

IPC-HFW1435S-W-S2

4MP IR Bullet WI-Fi Camera



- 4MP, 1/3" CMOS image sensor, low illuminance, high image definition
- Outputs max. 4MP (2560 × 1440) @20 fps
- H.265 codec, high compression rate, ultra-low bit rate
- Max. IR distance: 30 m
- ROI, SMART H.264/H.265, flexible coding, applicable to various bandwidth and storage environments
- Rotation mode, WDR, 3D DNR, HLC, BLC, digital watermarking, applicable to various monitoring scenes
- Supports 256 G Micro SD card
- 12V DC power supply, easy for installation
- IP67 protection
- Supports Wi-Fi



Series Overview

With features of simple installation, easy operation, and high performance-cost ratio, Dahua Entry series network camera is applicable to small and medium-sized scenes, such as homes/residences, small-sized retail stores, and other small and medium-sized enterprises.

Functions

Smart H.265+ & Smart H.264+

With advanced scene-adaptive rate control algorithm, Dahua smart encoding technology realizes the higher encoding efficiency than H.265 and H.264, provides high-quality video, and reduces the cost of storage and transmission.

WDR

With advanced Wide Dynamic Range (WDR) technology, Dahua network camera provides clear details in the environment of strong brightness contrast. The bright and dark area can get clear video even in high brightness environment or with backlight shadow.

Smart Illumination

Dahua Smart Illumination technology can display image in the environment of low illuminance or completely dark environment. According to the distance of the targets, the camera adjusts illuminations intensity automatically to display the details of the moving target.

Motion Detection

When moving objects appear in the monitoring image, Dahua Motion Detection (General) technology triggers alarm or records.

Day/Night

Dahua Day/Night function provides color image when illumination is adequate; when illuminance is inadequate, it switches night mode and provides white and black image. It can guarantee that the network camera can work normally when illuminance changes.

Protection (IP67, wide voltage)

IP67: The camera passes a series of strict test on dust and soak. It has dust-proof function, and the enclosure can works normal after soaking in 1 m deep water for 30 minutes.

Wide voltage: The camera allows $\pm 30\%$ input voltage tolerance (wide voltage range), and it is widely applied to outdoor environment with instable voltage.

Technical Specification

Camera	
Image Sensor	1/3"4Megapixel progressive CMOS
Max. Resolution	2560 (H) × 1440 (V)
ROM	128 MB
RAM	256 MB
Scanning System	Progressive
Electronic Shutter Speed	Auto/Manual 1/3 s–1/100,000 s
Min. Illumination	Manual 1/30 s 0.9343 Lux @F2.0 (Color, 80 IRE); 0.9258 Lux @F2.0 (W/B, 80 IRE); 0 Lux (IR on) Manual 1/3 s 0.1195 Lux @F2.0 (Color, 80 IRE); 0.1190 Lux @F2.0 (W/B, 80 IRE); 0 Lux (IR on)
S/N Ratio	>52 dB
Illumination Distance	30 m (98.4 ft)
Illuminator On/Off Control	Auto
Illuminator Number	18 (IR LED)
Pan/Tilt/Rotation Range	Pan: 0°–360° Tilt: 0°–90°

Lens	
Lens Type	Fixed-focal
Mount Type	M12
Focal Length	2.8 mm 3.6 mm
Max. Aperture	F2.0
Field of View	2.8 mm: Horizontal: 97° Vertical: 52° Diagonal: 116° 3.6 mm: Horizontal: 76° Vertical: 42° Diagonal: 90°
Iris Type	Fixed
Close Focus Distance	2.8 mm: 0.8 m (2.6 ft) 3.6 mm: 1.4 m (4.6 ft)

DORI Distance	Lens	Detect	Observe	Recognize	Identify
	2.8mm	56 m (183.7 ft)	22.4 m (73.5 ft)	11.2 m (36.7 ft)	5.6 m (18.4 ft)
	3.6mm	80 m (262.5 ft)	30m (105.0 ft)	16m (52.5 ft)	8m (26.2 ft)

Video	
Video Compression	H.265; H.264; H.264H; H.264B; MJPEG
Smart Codec	H.264: Yes H.265: Yes
Video Frame Rate	50 Hz Main stream (2560 × 1440 @20 fps), sub stream (640 × 480 @20 fps) Main stream (2304 × 1296 @25 fps), sub stream (640 × 480 @25 fps) 60 Hz Main stream (2560 × 1440 @20 fps), sub stream (640 × 480 @20 fps) Main stream (2304 × 1296 @30 fps), sub stream (640 × 480 @30 fps)

Stream Capability	2 streams
Resolution	4M (2560 × 1440); 2M (2304 × 1296); 1080p (1920 × 1080); 1.3M (1280 × 960); 720p (1280 × 720); VGA (640 × 480); QVGA (320 × 240)
Bit Rate Control	CBR/VBR
Video Bit Rate	H.264: 24 kbps–8192 kbps H.265: 9 kbps–7424 kbps
Day/Night	Auto (ICR)/Color/B/W
BLC	Yes
HLC	Yes
WDR	DWDR
White Balance	Auto/natural/street lamp/outdoor/manual/regional custom
Gain Control	Auto/Manual
Noise Reduction	3D DNR
Motion Detection	OFF/ON (4 areas, rectangular)
Region of Interest (RoI)	Yes (4 areas)
Smart Illumination	Yes
Image Rotation	0°/90°/180°/270° (Support 90°/270° with all resolution)
Mirror	Yes
Privacy Masking	4 areas

Alarm	
Alarm Event	No SD card; SD card full; SD card error; network disconnection; IP conflict; illegal access; voltage detection; motion detection; video tampering

Network	
Network	RJ-45 (10/100 Base-T)
Wi-Fi	Yes
SDK and API	Yes
Protocol	HTTP; TCP; ARP; RTSP; RTP; UDP; RTCP; SMTP; FTP; DHCP; DNS; IPv4/v6; QoS; NTP
Interoperability	ONVIF (Profile T/Profile S/Profile G); CGI; DMSS
User/Host	20 (Total bandwidth: 40 M)
Storage	FTP; SFTP; Micro SD card (256 G); NAS
Browser	IE: IE9, IE11 and later Chrome: 39.0.2171.95, and later version without plug-in (62.0.3202.94) Firefox: 43.0.1 and later version without plug-in (69.0.3)
Management Software	DMSS
Mobile Phone	IOS; Android

Certification	
Certification	CE-LVD: EN62368-1 CE-EMC: Electromagnetic Compatibility Directive 2014/30/EU CE-RED: Radio Equipment Directive 2014/53/EU FCC: 47 CFR FCC Part 15, Subpart B FCC ID: FCC PART 15C

Power

Power Supply	12V DC
Power Consumption	Max 5.39W (12V DC) (IR full intensity)

Environment

Operating Conditions	-30°C to +50°C (-22°F to +122°F)/Less than 95%RH
Storage Conditions	-40°C to +60°C (-40°F to +140°F)
Protection Grade	IP67

Structure

Casing	Metal
Dimensions	164.9 mm × 70 mm × 125.2 mm (6.5" × 2.8" × 4.9") (L × W × H)
Net Weight	431 g (1.0 lb)
Gross Weight	708 g (1.6 lb)

Dimensions (mm[inch])

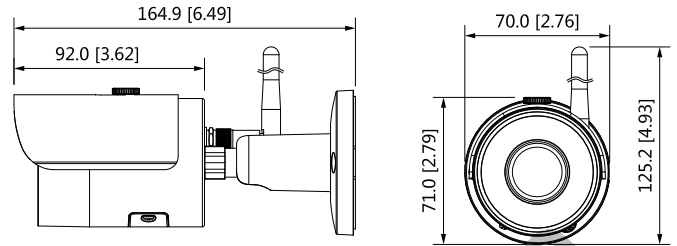

Ordering Information

Type	Model	Description
4MP Camera	DH-IPC-HFW1435SP-W-0280B-S2	4MP IR BULLET Wi-Fi Camera, PAL
	DH-IPC-HFW1435SN-W-0280B-S2	4MP IR BULLET Wi-Fi Camera, NTSC
	DH-IPC-HFW1435SP-W-0360B-S2	4MP IR BULLET Wi-Fi Camera, PAL
	DH-IPC-HFW1435SN-W-0360B-S2	4MP IR BULLET Wi-Fi Camera, NTSC
Accessories (optional)	PFA134	Junction Box
	PFA152-E	Pole Mount

Accessories

Optional:



PFA134
Junction Box



PFA152-E
Pole Mount

