

- 100% before shipment testing, stable and reliable long-term quality
- patented grid alloy formula and updated manufacturing technique
- completely sealed and maintenance-free, low self-discharge
- Excellent charging and re-charging acceptance
- Cycle use: More than 260 cycles at 100% DOD
- Floating & standby use: 3-5 years

Application:

- Alarm System
- Cable Television
- Communication Equipment
- Emergency Power System
- Security System
- Medical Equipment
- UPS
- Power tools
- Control Equipment
- Toys

Construction:

- ComponentRaw material
- PositiveLead dioxide
- NegativeLead
- ContainerABS
- CoverABS
- SealantEpoxy
- Safety valve Rubber
- TerminalCopper
- SeparatorFiber glass
- ElectrolyteSulfuric acid

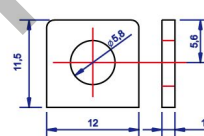

M5 Bolt & Nut

T1 Terminal

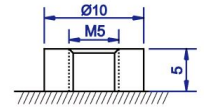

M5 Bolt

B1 Terminal

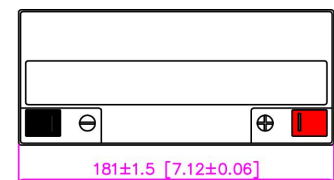
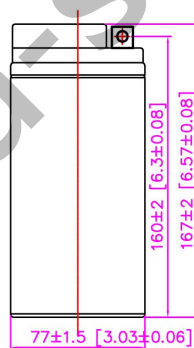
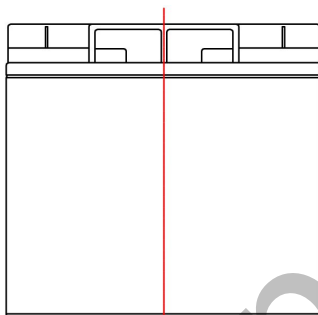

Specification:

Battery Model	12V12AH			
Designed Floating Life	3~5 Years			
Capacity (25°C)	20HR(0.600A,10.5V)	10HR(1.099A,10.5V)	5HR(1.972A,10.5V)	1HR(6.720A,10.5V)
	12.00 AH	10.99 AH	9.86 AH	6.72 AH
Dimensions	Length	Width	Height	Total Height
	181 mm	77 mm	160 mm	167 mm
Approx. Weight	4.00Kg ±3%			
Internal Resistance	Full charged at 25°C : ≤19.00 mΩ			
Self Discharge	2% of capacity declined per month at (25°C)			
Capacity Affected by Temp.(20HR)	40°C	25°C	0°C	-15°C
	102%	100%	85%	65%
Charge Voltage(25oC)	Cycle use		Float use	
	14.4-15.0V(-30mV/°C), max. Current:3.20A		13.5-13.8V (-20mV/°C)	

Terminal Voltage (V) and Discharge Time



Capacity Retention Characteristic

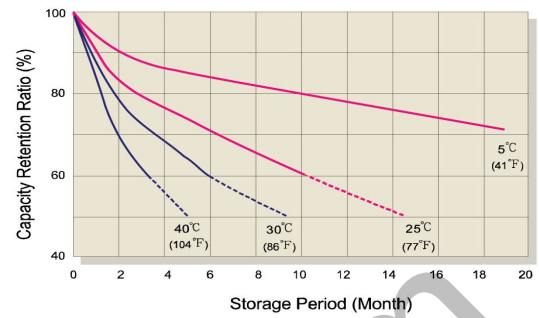

Battery Voltage and Charge Time for Standby Use



Battery Voltage and Charge Time for Cycle Use

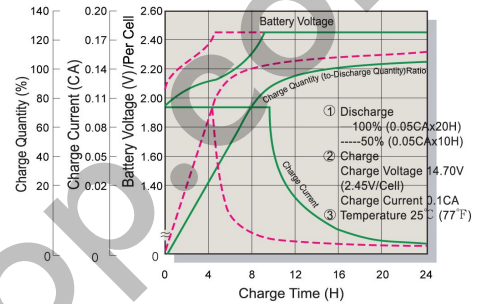

Tickle(or Float) Service Life

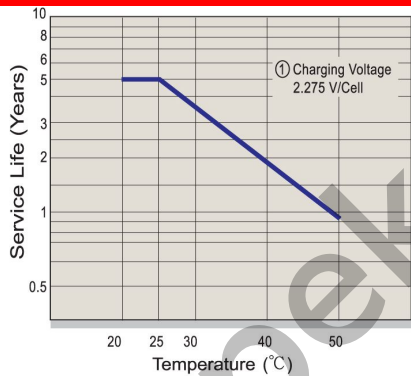

Cycle Service Life

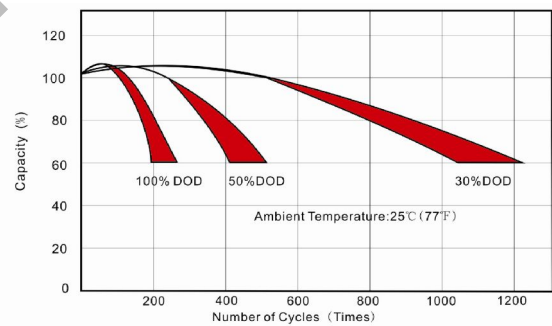

Constant Current Discharge(CC,Unit:A) at 25°C(77°F)

F.V/Time	5Min	10Min	15Min	30Min	1Hr	2Hr	3Hr	4Hr	5Hr	6Hr	10Hr	20Hr
1.80V/Cell	37.73	26.04	18.03	11.19	6.59	3.85	2.93	2.330	1.935	1.653	1.078	0.589
1.75V/Cell	38.44	26.53	18.37	11.40	6.72	3.92	2.99	2.374	1.972	1.684	1.099	0.600
1.70V/Cell	39.59	27.33	19.47	11.85	6.83	3.99	3.04	2.415	2.006	1.714	1.118	0.611
1.67V/Cell	40.74	28.12	21.13	12.51	6.91	4.04	3.07	2.441	2.028	1.732	1.130	0.617
1.60V/Cell	41.90	28.92	22.23	13.05	6.98	4.08	3.10	2.468	2.050	1.751	1.142	0.624

Constant Power Discharge (CP,Unit:W) at 25°C(77°F)

F.V/Time	5Min	10Min	15Min	30Min	1Hr	2Hr	3Hr	4Hr	5Hr	6Hr	10Hr	20Hr
1.80V/Cell	73.57	50.78	35.16	21.81	12.86	7.51	5.72	4.54	3.77	3.22	2.10	1.15
1.75V/Cell	74.95	51.73	35.82	22.22	13.10	7.65	5.82	4.63	3.84	3.28	2.14	1.17
1.70V/Cell	77.20	53.28	37.97	23.11	13.33	7.79	5.93	4.71	3.91	3.34	2.18	1.19
1.67V/Cell	79.45	54.84	41.20	24.40	13.47	7.87	5.99	4.76	3.95	3.38	2.20	1.20
1.60V/Cell	81.70	56.39	43.35	25.44	13.62	7.96	6.05	4.81	4.00	3.41	2.23	1.22